

Performance

- Frequency: 14~18GHz
- Typical Signal Gain: 29dB
- Typical Pout: 46.5dBm@28V
- Typical PAE: 30%
- Bias: 28V, -2V (Typ.)
- Size: 18.03mm*8.7mm*2.5mm

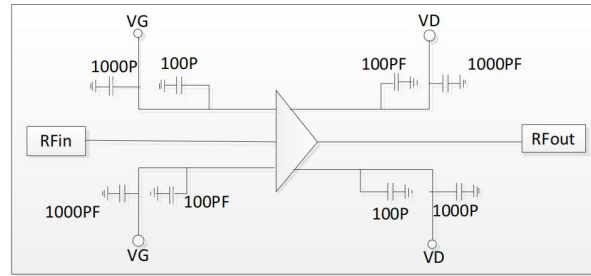

Electrical Specifications (TA=25°C, Vd=28V, Vg=-2V, F: 14~18GHz, tw=100us, D=10%)

Symbol	Parameter	Min	Typical	Max	Unit
G	Small Signal Gain	-	29	-	dB
Gp	Power Gain	-	21.5	-	dB
Pout	Saturated Power	-	46.5	-	dBm
PAE	Power Added Efficiency	-	30	-	%

Test Curves

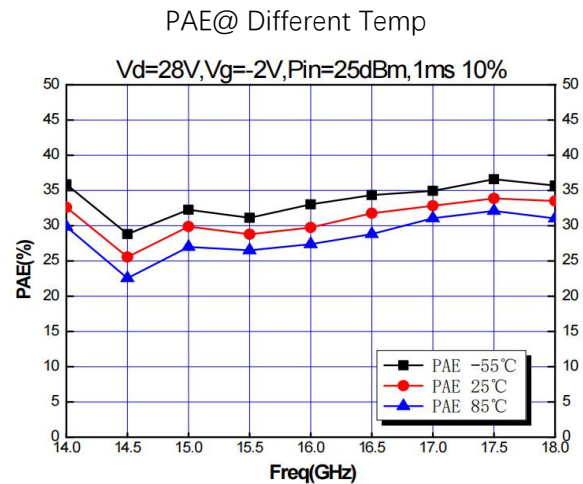
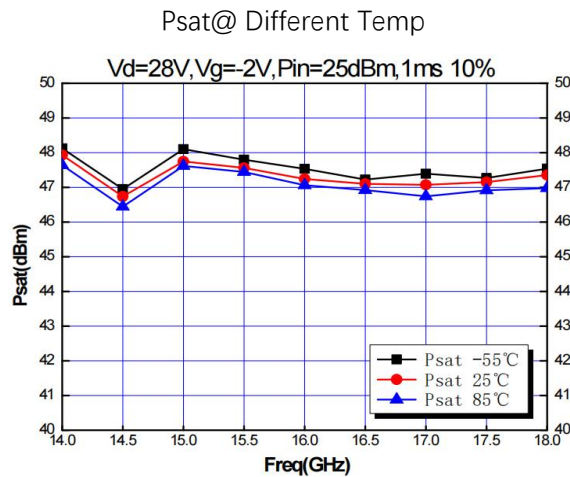

Absolute Max Ratings (TA=25°C)

Symbol	Parameter	Value	Remark
Vd	Drain Voltage	32V	
Vg	Grid Voltage	-10V	
Ig	Gate Current	100mA	
Pin	Input Power	30dBm	
VSWRout	Output VSWR	5:1	
Tm	Mounting Temperature	220°C	
Tstg	Storage Temperature	-55~125°C	
ESD	ESD Sensitivity, Human Body Model	Class A	

[1] Exceeding any one or combination of these limits may cause permanent damage.

Outline Drawing

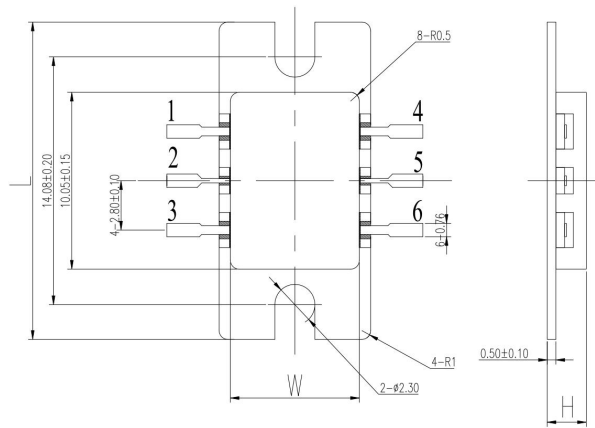

Symbol	Parameter		
	Min	Typical	Max
H	-	2.24	2.50
L	17.83	18.03	18.23
W	8.5	8.70	8.90

Unit: mm

Pads Definition

Pin No.	Pad	Pin No.	Pad
1	VG	4	VD
2	RFin	5	RFout
3	VG	6	VD

Recommended External Capacitor

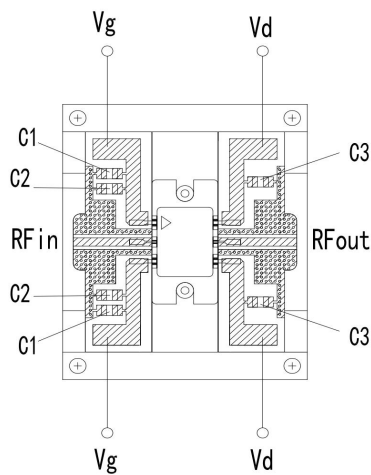

No.	Recommended Capacitance
C1	10uF
C2	1uF
C3	1000pF

Note:

- 1、 Apply the transmission line configuration as shown in drawing at RF input and output ports during usage.
- 2、 Apply recommended operating voltage during turn on procedure.
- 3、 When the module is operating under CW mode, add additional μ grade filter capacitors near Vd port as closely as possible.
- 4、 If you use voltage stabilizer to switch the voltage, please make sure the selected stabilizer has higher over-current ability than recommended operating current.
- 5、 During turn on procedure, first negative then positive time sequense.
- 6、 Pay attention to current limiting during usage.
- 7、 Make sure of well grounding during usage.
- 8、 Pay attention to ESD protection during usage, storage and transportation.
- 9、 Operating temperature has to be controlled strictly within the range data sheet specified.
- 10、 When there's a quality issue, please return it to manufacture for repair, don't open the lid by yourself.